



RV lift system is the best modification to increase RV space.

The ability to raise and lower the roof of a motorhome is key to ensuring the flexibility and comfort of the interior space.

Its function is to adjust the height of the RV's roof by raising and lowering it to meet different needs and usage scenarios.

The design of the RV roof lift rod utilizes high-strength alloy materials and professional machinery.

The structural design ensures its safety and reliability during lifting and lowering. It withstands...

The weight of the RV roof and external environmental factors such as wind force mean that materials and...

Both are structurally more robust and stable.

GeMin offers effective solutions, in addition to lifting functions, for rooms

The roof lift boom also has a locking function to ensure the roof remains secure during raising and lowering.

Stability and safety. The locking lever is typically located at the bottom or top of the lifting bar, and...

The position of the fixed lifting rod is used to prevent the ceiling from rising or falling unexpectedly due to external force or vibration.

TL2F

Series

Lifting Electric Cylinder

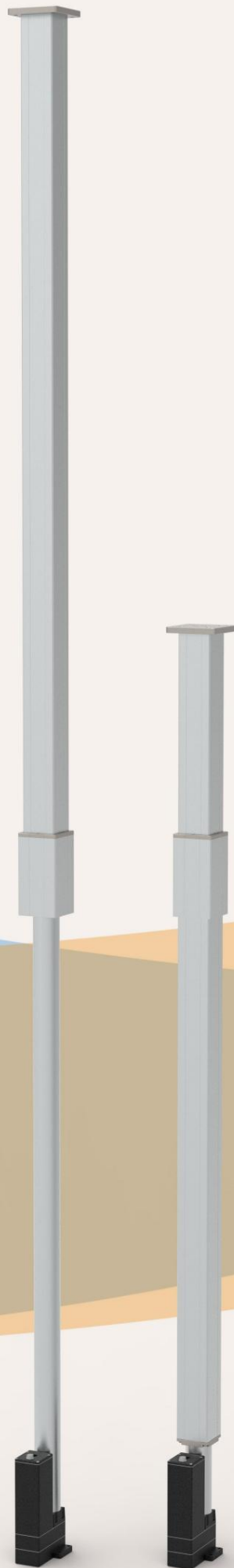

Smart and comfortable actions

The motor system is cleverly concealed under the bed, making the best use of available space. The system is designed to fit on a bed for easy cleaning or placement.

An innovative solution.



TL2F

Series
pushrod actuators



Product Category

1. Automotive Applications
2. RV Applications

The adjustable roof design allows the RV roof to be raised at different heights to adapt to various usage scenarios. For example, when parked, the roof can be raised to increase interior space and ventilation; while when moving or stationary, the roof can be lowered to reduce wind resistance and vehicle height. This improves stability and maneuverability, allowing the RV to provide a comfortable living space in various environments.

Function Overview

Voltage range:	24V DC or 48V DC
Maximum thrust:	3000-6000N
Speed at full load:	20 - 10 mm / s
Travel range:	500 - 2000 MM
Retract to initial height:	2200MM (Custom sizes 1000-2500MM)
Dynamic lateral moment:	850 Nm
Static lateral moment:	1500 Nm
Positioning repeatability:	±0.2~1 MM
Robot compatibility:	Any motorhome
Body weight:	with 0 travel weight 25KG, @500MM travel weight +2.5KG
Security Certification:	Comply with ISO9001-2008.
Operating temperature range:	-35 ° C ~ + 75 ° C +5 ° C ~ + 45 ° C
Complete performance temperature range:	IP65
Protection rating:	The default is a trapezoidal lead screw; a ball screw is optional.
Screw selection:	Feedback - Jobs and Status - Accessible Jobs
Other options:	Synchronous control, soft start and stop - achieving smooth operation EtherCAN/ Modbus RTU (customizable) with built-in high
Control options:	and low limit signals (PNP).
Communication protocol:	
Origin signal:	

Engineering drawings

Standard size
MM

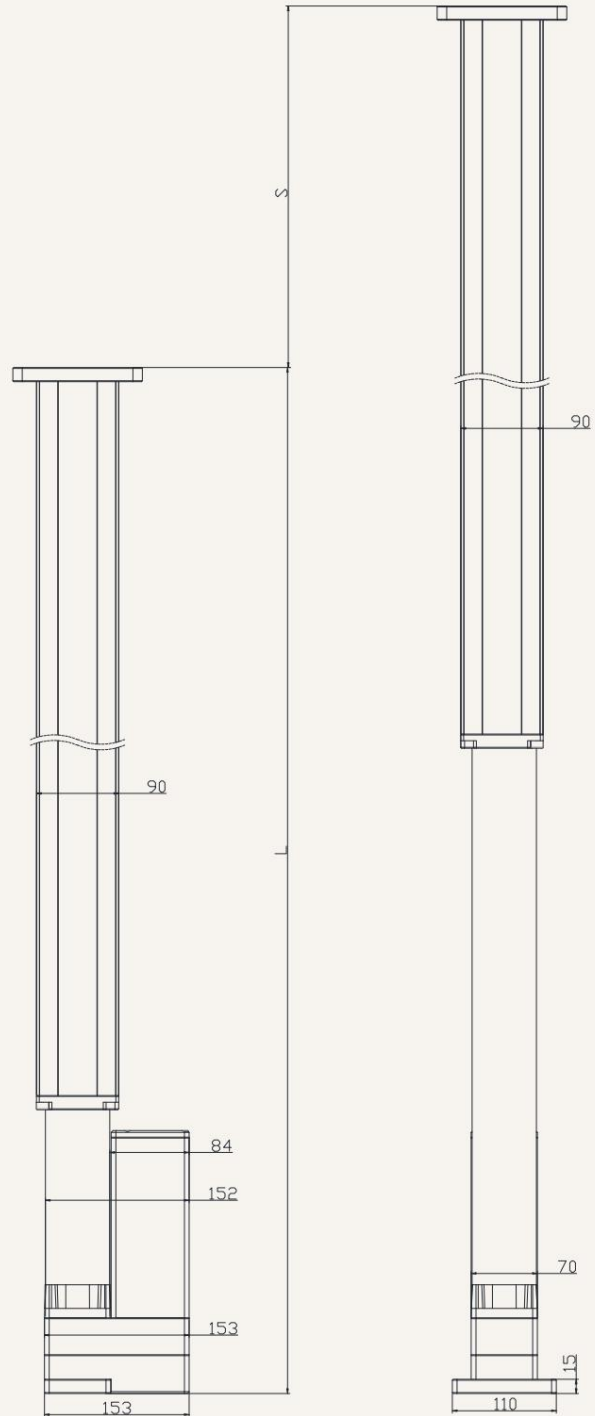
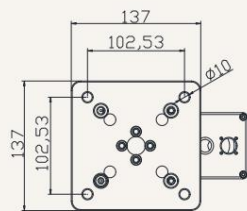
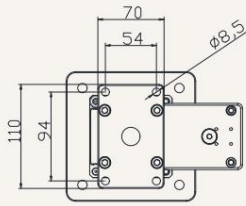

S: Itinerary Stroke
 L: Minimum height (Retracted length)
 $L = \text{Stroke} + 500 \text{ MM}$
 Standard travel: 1700mm,
 initial retraction height: 2200mm,
 maximum lifting height: 3900mm

TK82F

Series

Lifting Electric Cylinder



Engineering drawings

Standard size

MM

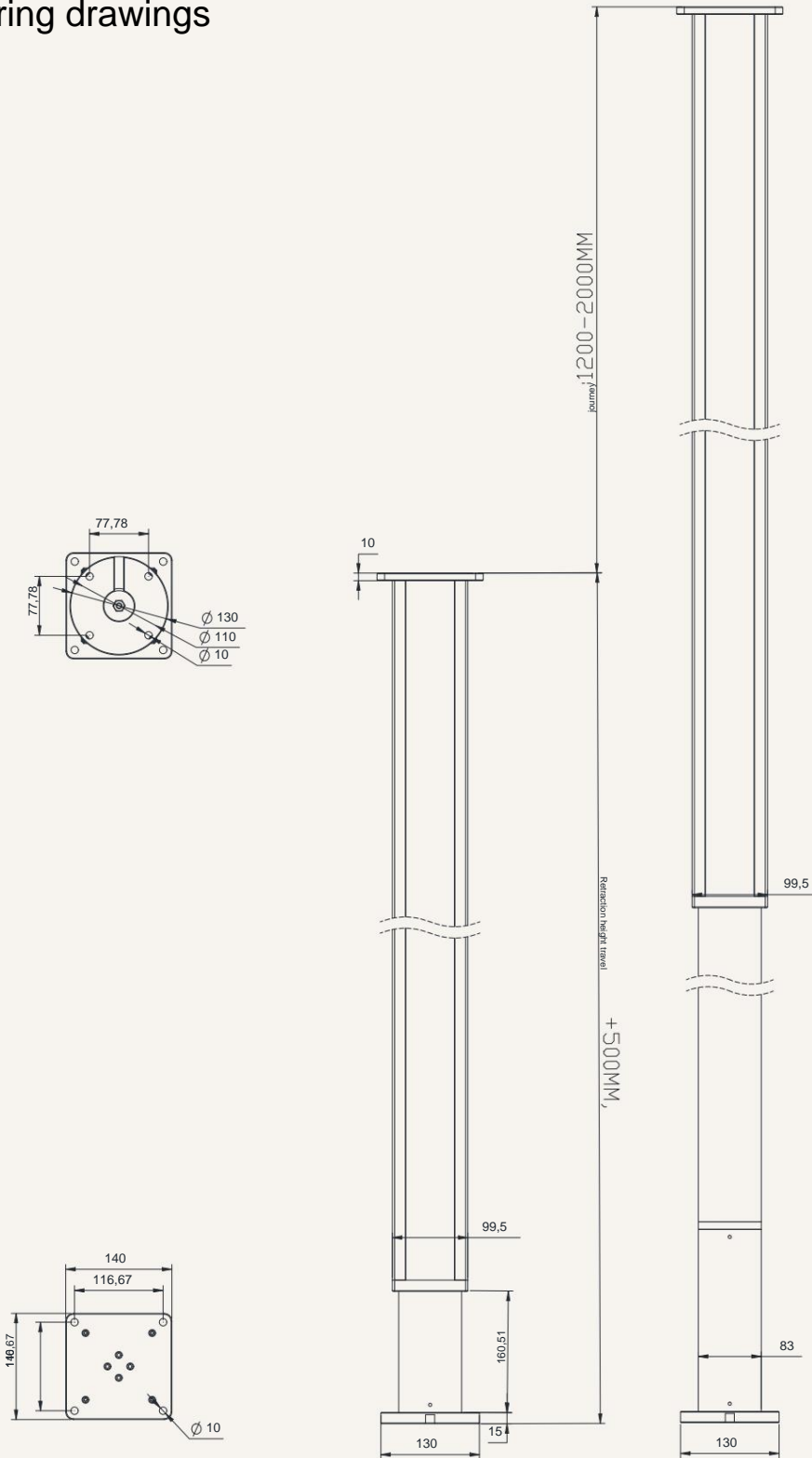

S: Itinerary Stroke

L: Minimum height (Retracted length)

$L = \text{Stroke} + 500 \text{ MM}$

Standard travel: 1700mm,

initial retraction height: 2200mm,

maximum lifting height: 3900mm

TK75

Series

Lifting Electric Cylinder



Engineering drawings

Standard size
MM

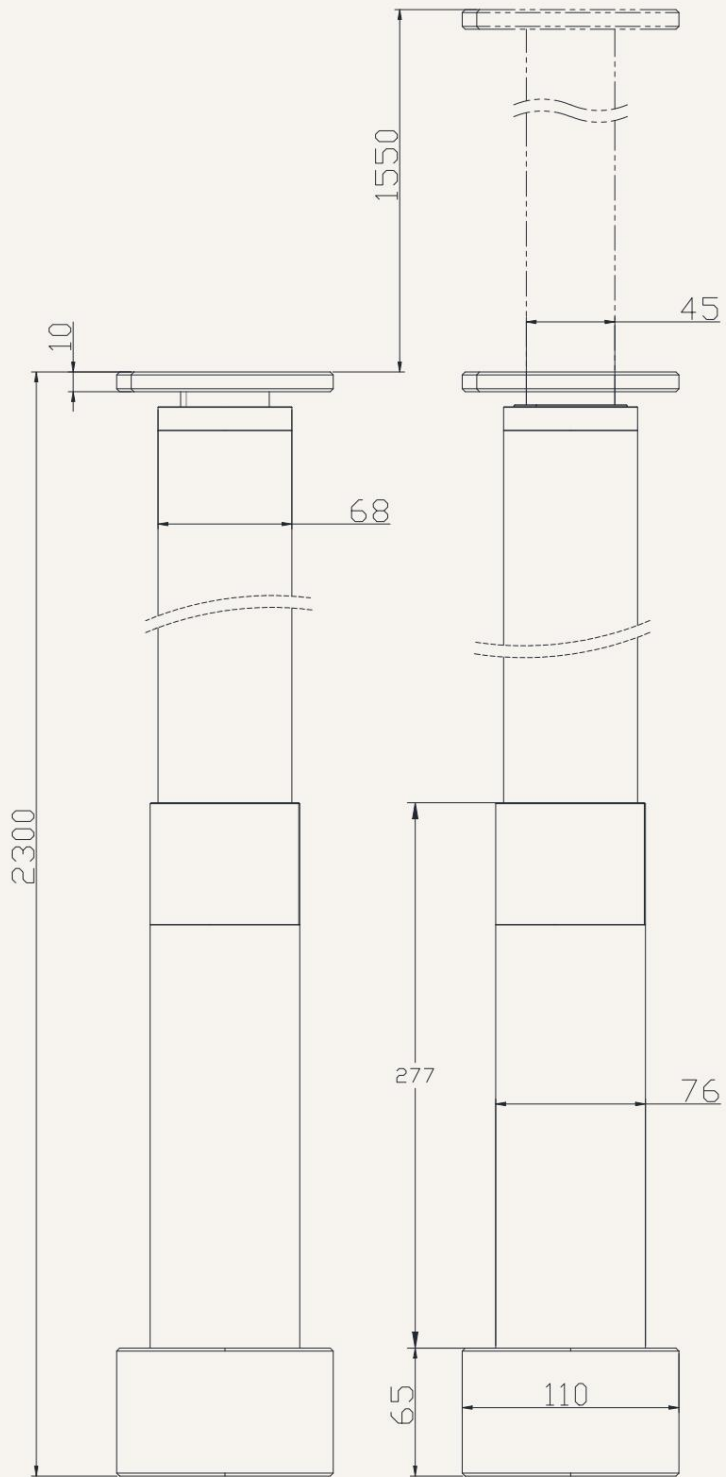
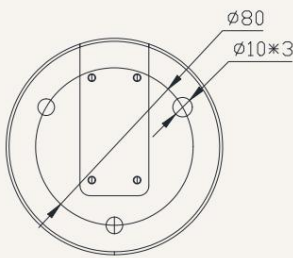
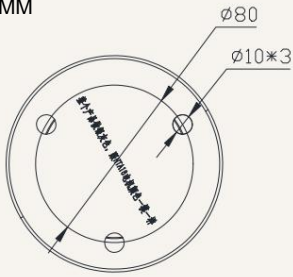

S: Itinerary Stroke
 L: Minimum height (Retracted length)
 $L = \text{Stroke} + 550 \text{ MM}$
 Standard travel: 1700mm,
 initial retraction height: 2400mm,
 maximum lifting height: 4100mm

Smart and comfortable actions

The motor system is cleverly concealed under the bed, making the best use of available space. The system is designed to fit on a bed for easy cleaning or placement. An innovative solution.



B3SD

Series

Double Matryoshka Top

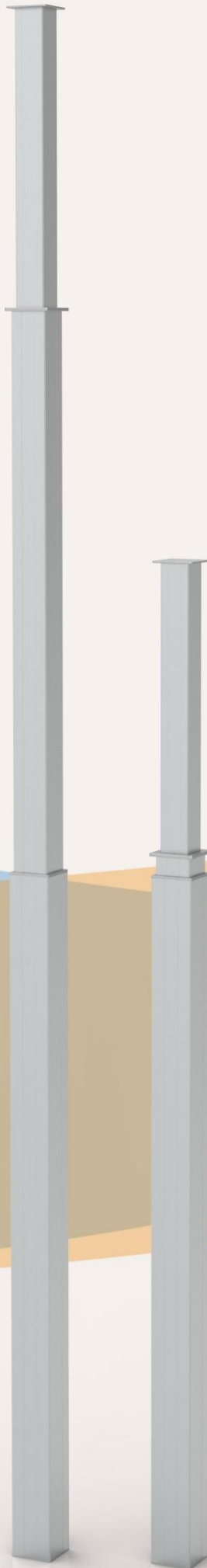

TL2+TL3

Series

Double Matryoshka Top



TL28

Series

Lifting Electric Cylinder



Standard size
MM

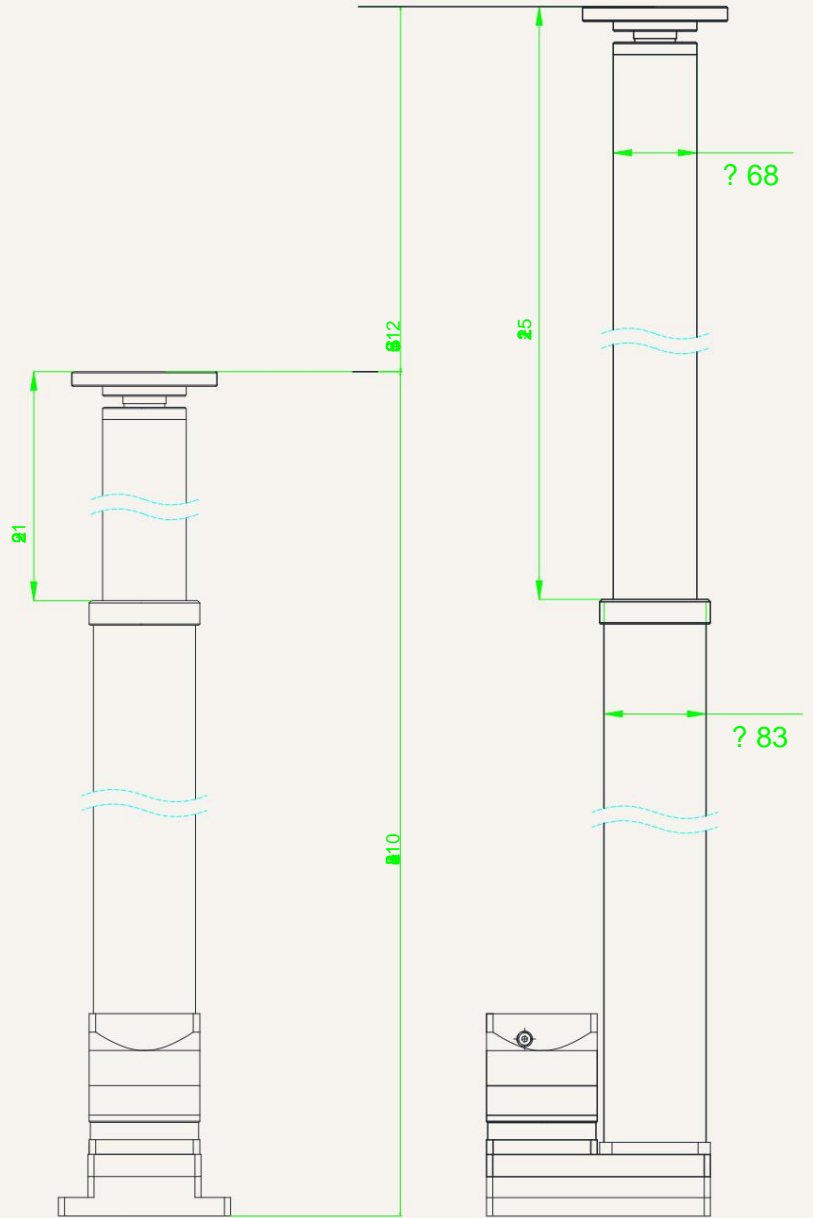
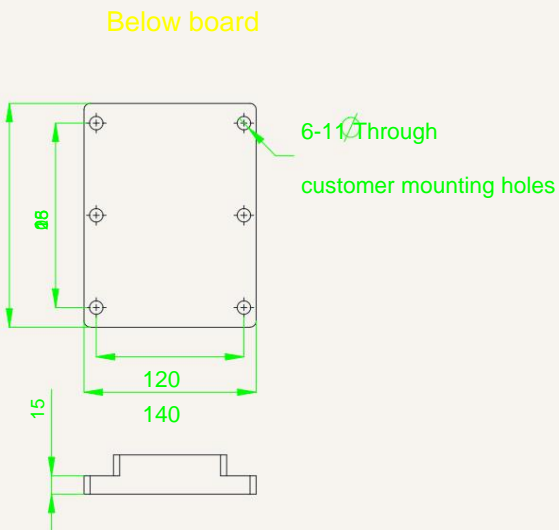
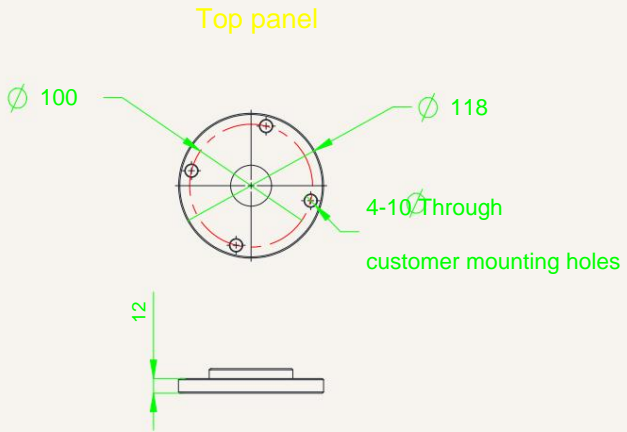

S: Itinerary Stroke

L: Minimum height (Retracted length)

$L = \text{Stroke} + 550 \text{ MM}$

Standard travel: 1700mm, initial retraction height: 2400mm, maximum lifting height: 4100mm

TL29

Series

Lifting Electric Cylinder



Engineering drawings

Standard size
MM

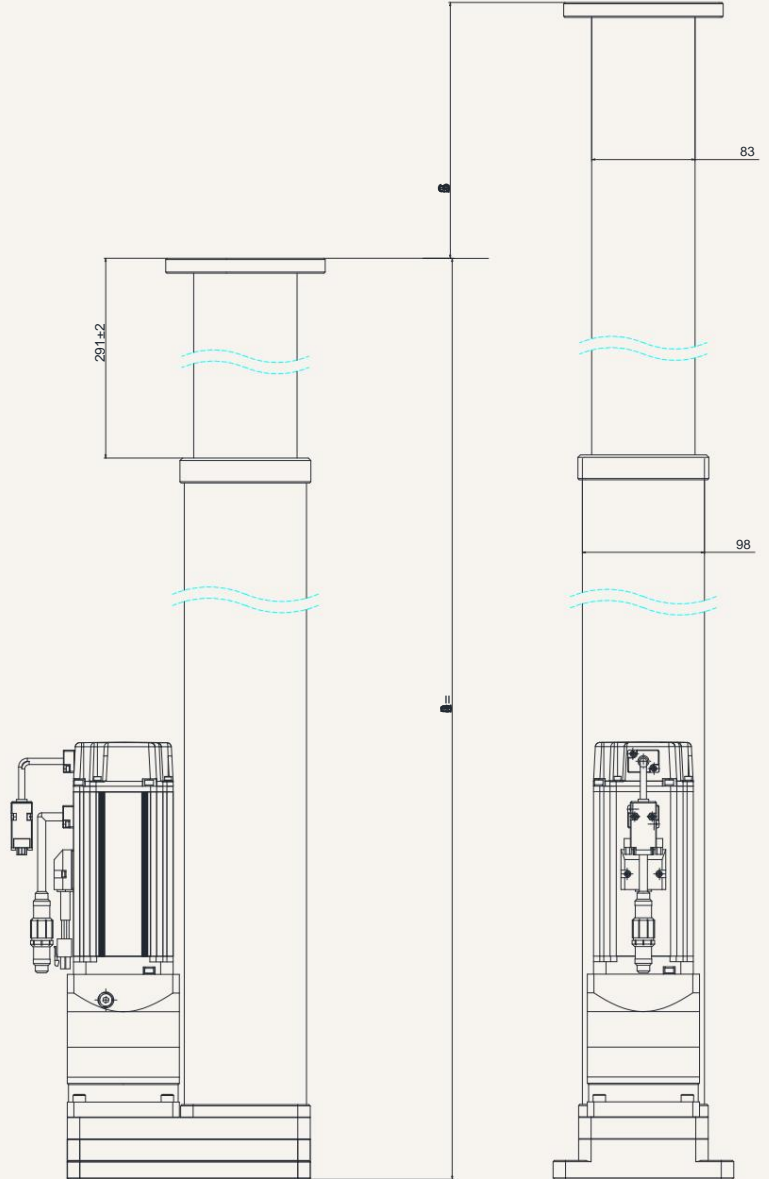
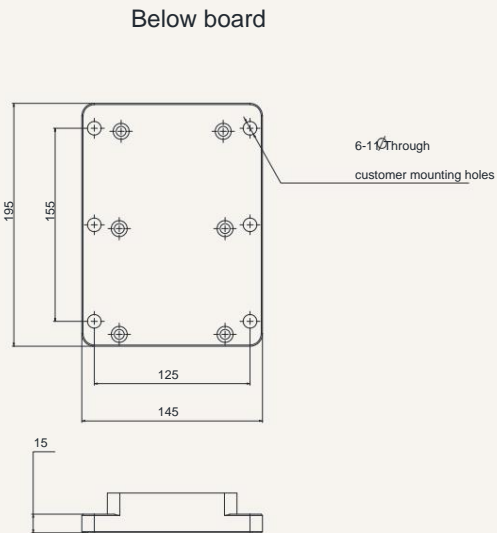
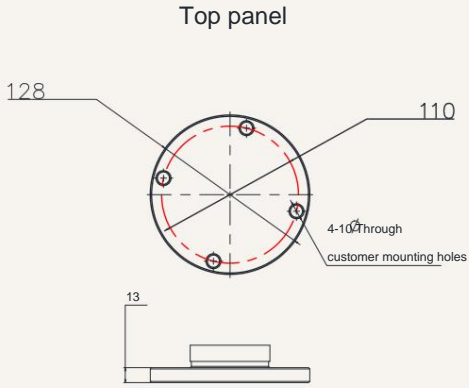

S: Itinerary Stroke

L: Minimum height (Retracted length)

$L = \text{Stroke} + 550 \text{ MM}$

Standard travel: 1700mm, initial retraction height: 2400mm, maximum lifting height: 4100mm

TL39

Series

Electric cylinder with sleeve



Standard size
MM

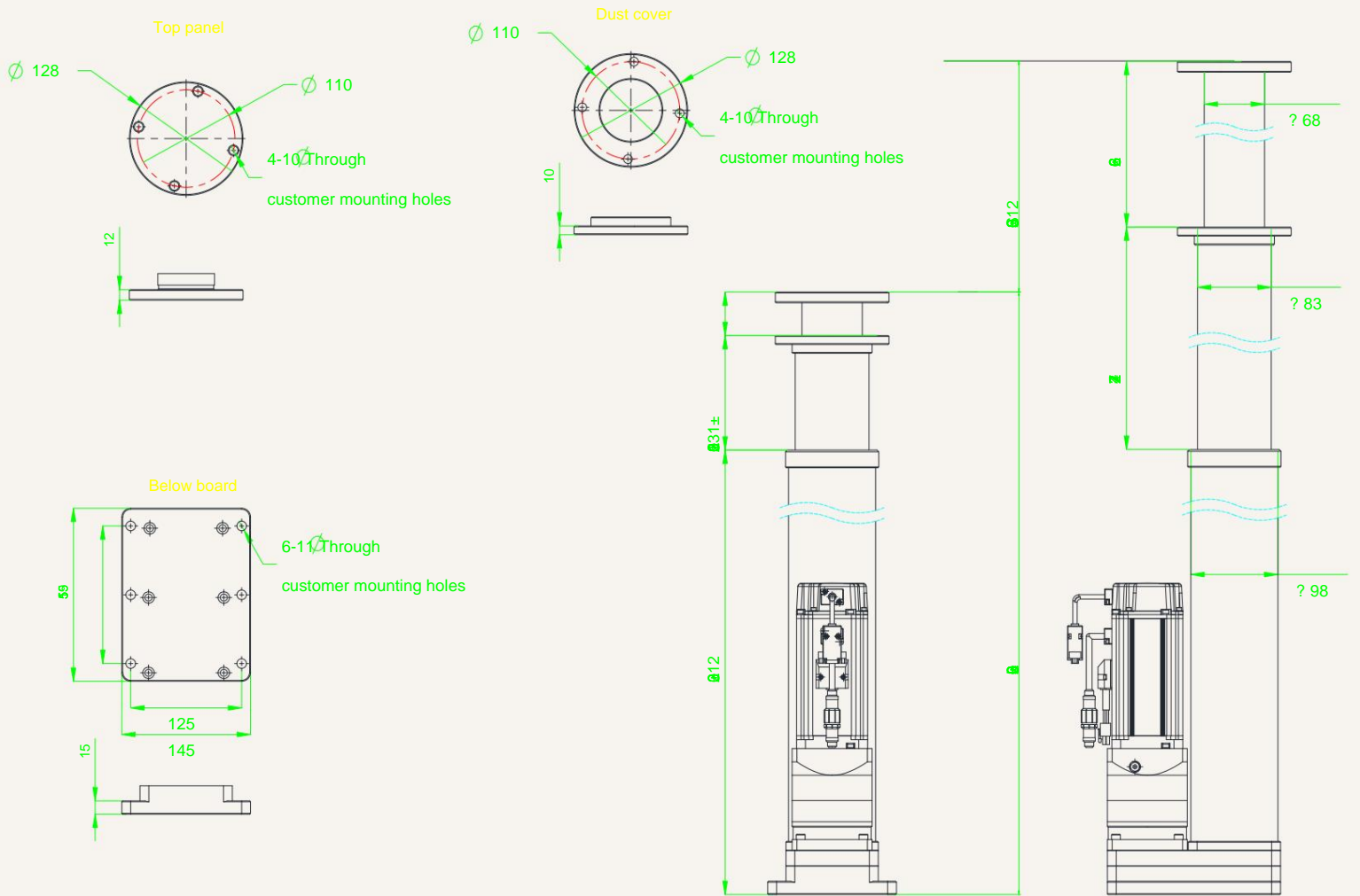

S: Itinerary Stroke

L: Minimum height (Retracted length)

$L = \text{Stroke}/2 + 550 \text{ MM}$

Standard travel: 1700mm, initial retraction height: 2400mm, maximum lifting height: 4100mm

TL29+F75

Series

Single Matryoshka Doll Top



Standard size
MM

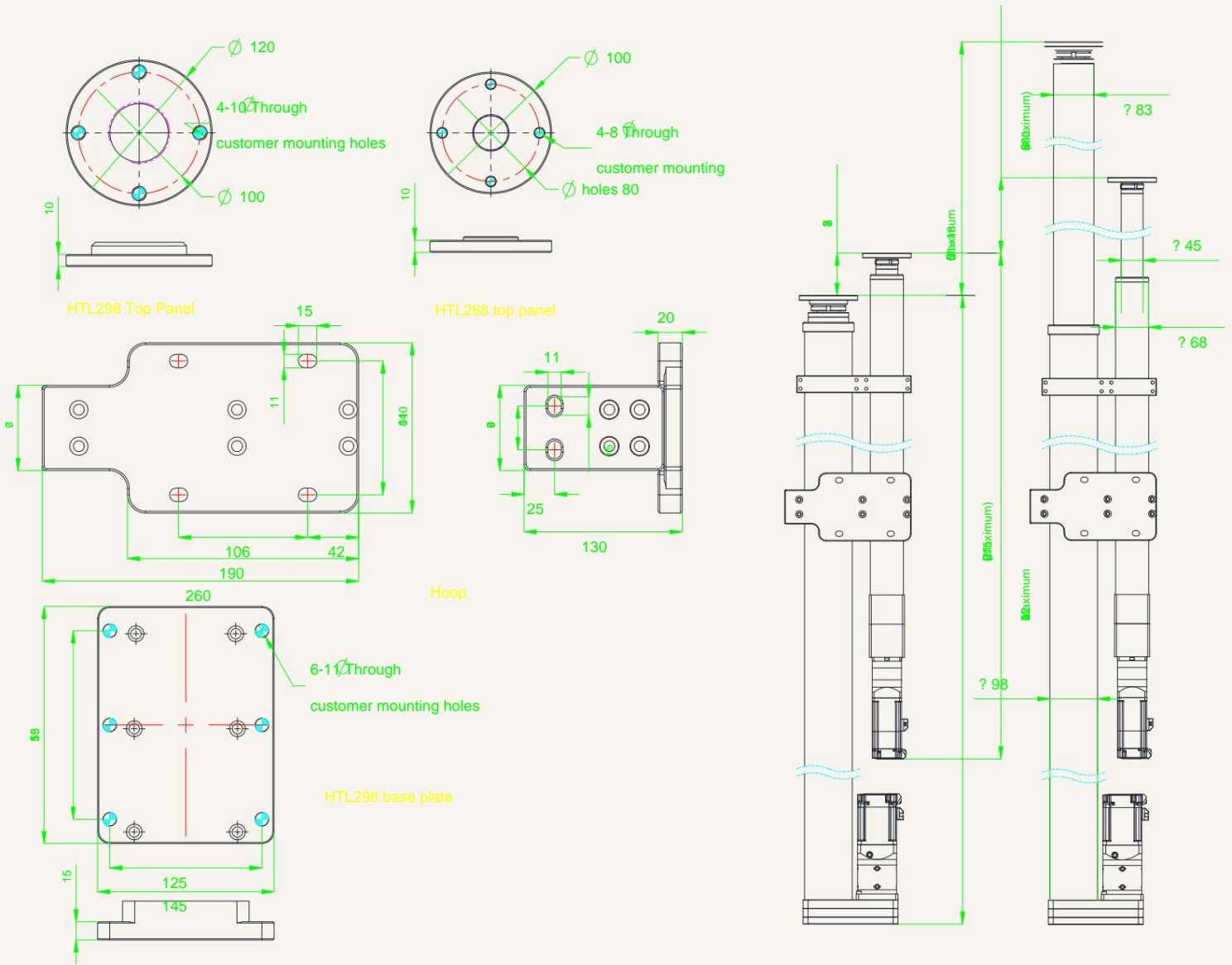

S: Itinerary Stroke

L: Minimum height (Retracted length)

$L = \text{Stroke} + 550 \text{ MM}$

For a stroke greater than 1000 mm, the installation dimension $L = \text{stroke} + 600 \text{ mm}$.

TL2Z

Series
pushrod actuators



Product Category

1. Emergency vehicle application
2. RV Applications
3. Generator car

Parking lifters are key support devices for vehicles when parked, and they are mostly driven by mechanical or hydraulic methods to achieve height adjustment. Their main function is to stabilize the vehicle body and distribute the vehicle's weight by contacting the ground, effectively preventing tilting and swaying caused by uneven ground when parking. This device is widely used in RVs, trucks, and construction vehicles, ensuring the safety of loading and unloading goods while also improving the stability and comfort of RVs when parked. Parking is an important component of large vehicle parking systems.

Function Overview

Voltage range:	24V DC or 48V DC
Maximum thrust/ self-locking force:	2.5 tons / 7.0 tons
Speed at full load:	05 mm / s
Travel range:	100 - 500 MM
Retract to initial height:	travel +300mm
Dynamic lateral moment:	1000 Nm
Static lateral moment:	1500 Nm
Positioning repeatability:	±0.2~1 MM
Robot compatibility:	Any motorhome
Body weight:	with 0 travel weight 25KG,
Security Certification:	@500MM travel weight +2.5KG
Operating temperature range:	Comply with ISO9001-2008.
Complete performance temperature range:	-35 ° C ~ + 75 ° C
Protection rating:	+5 ° C ~ + 45 ° C
Screw selection:	IP65
Other options:	The default is a trapezoidal lead screw; a ball screw is optional.
Control options:	Feedback - Jobs and Status -
Communication protocol:	Accessible Jobs
Origin signal:	Synchronous control, soft start and stop - achieving smooth operation
	EtherCAN/Modbus RTU (customizable) with built-in high and low limit signals (PNP).

TL2ZA

Series

Electric lifting outriggers

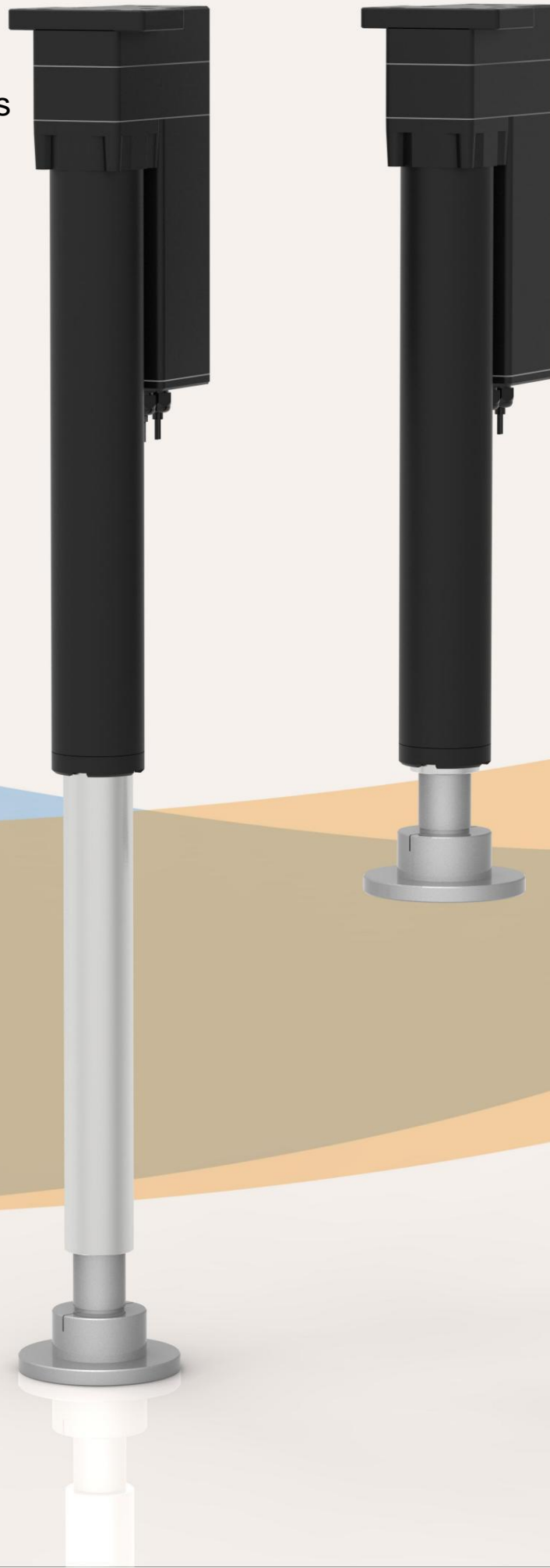

Engineering drawings

Standard size
MM

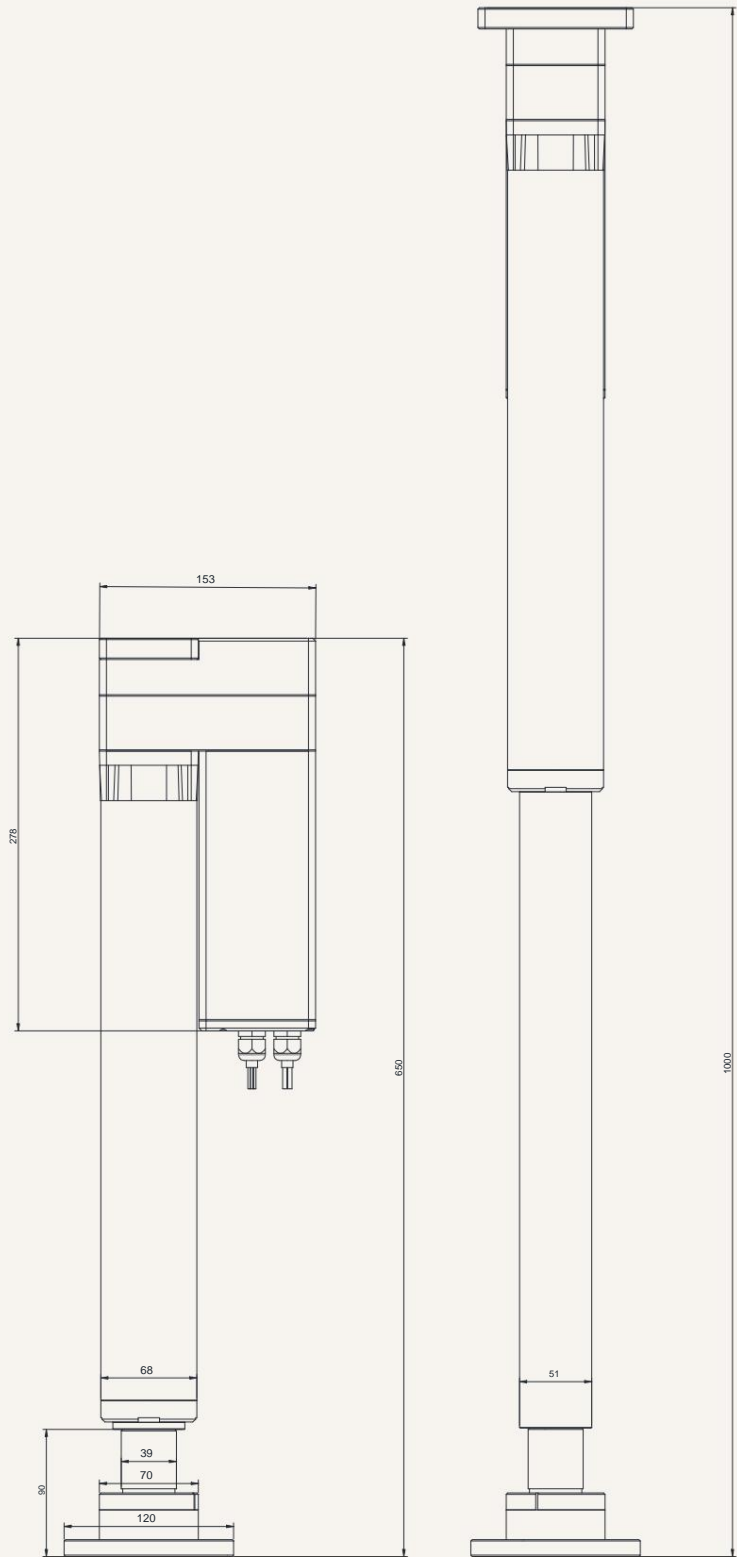
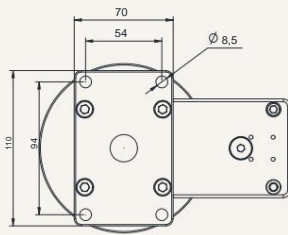
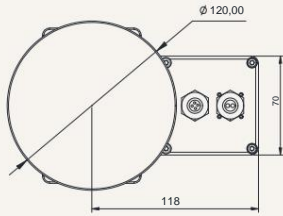

S: Itinerary Stroke

L: Minimum height (Retracted length)

$L = \text{Stroke} + 300 \text{ MM}$

Standard travel: 350mm; initial retraction height: 650mm; maximum lifting height: 1000mm

TL2ZB

Series

Electric lifting

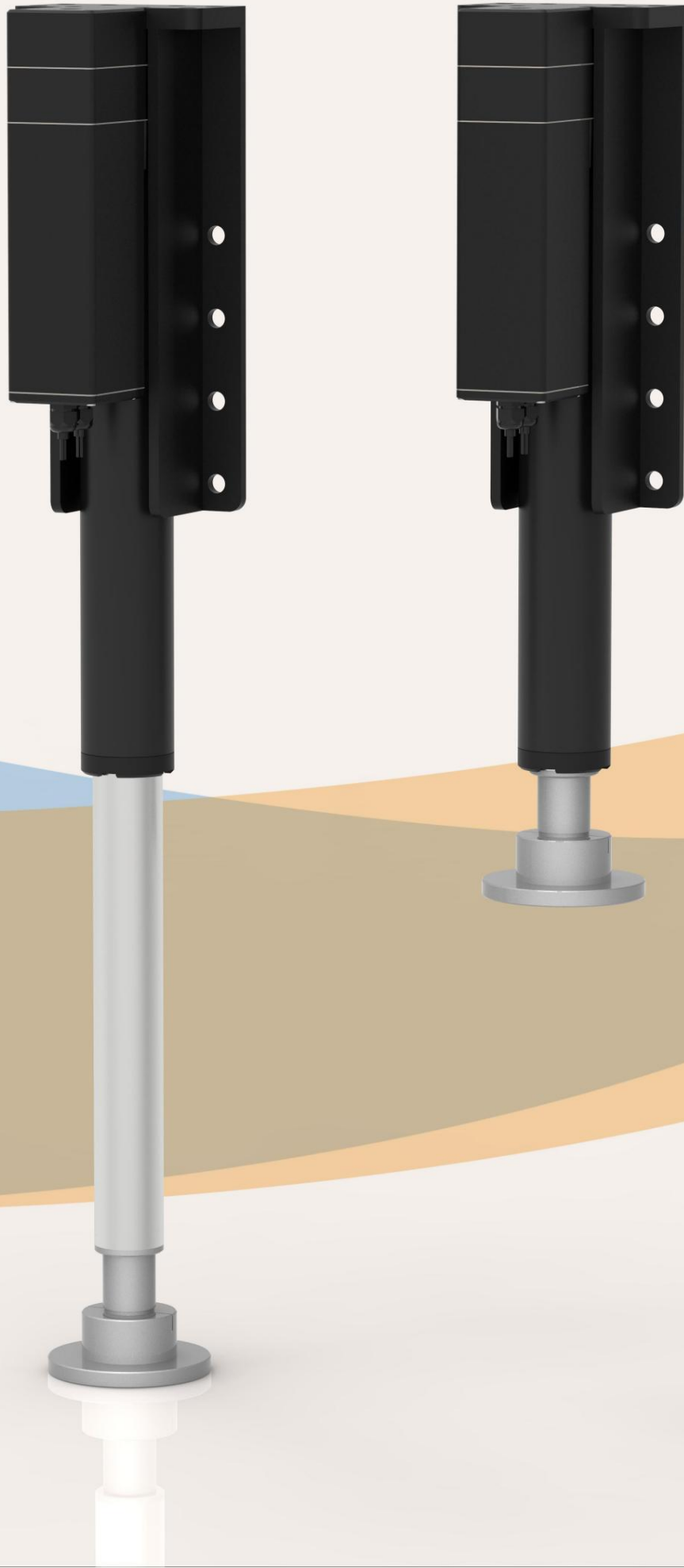

Standard size
MM

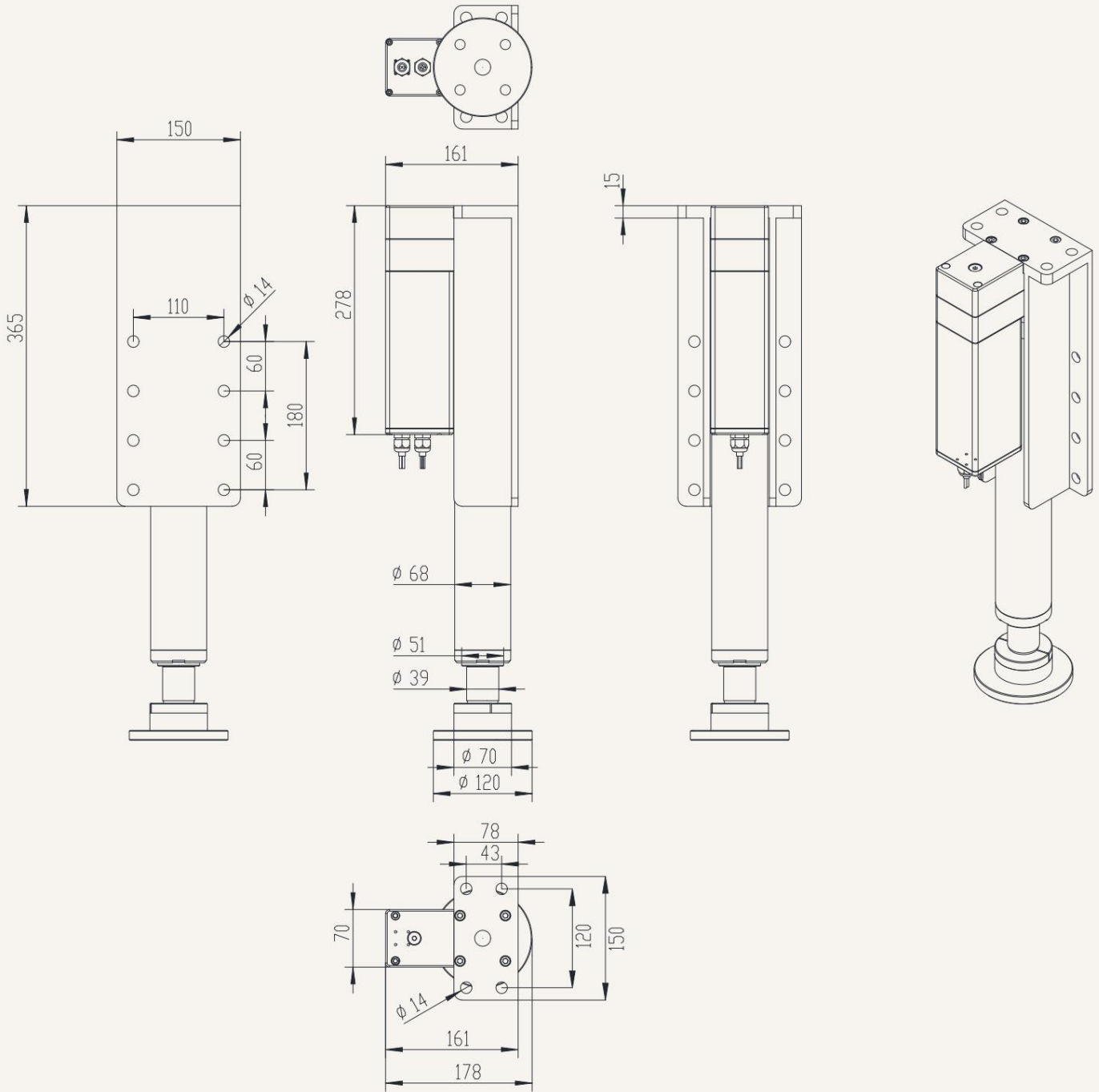

S: Itinerary Stroke

L: Minimum height (Retracted length)

$L = \text{Stroke} + 300 \text{ MM}$

Standard travel: 350mm; initial retraction height: 650mm; maximum lifting height: 1000mm

W90ZB

Series

Electric lifting

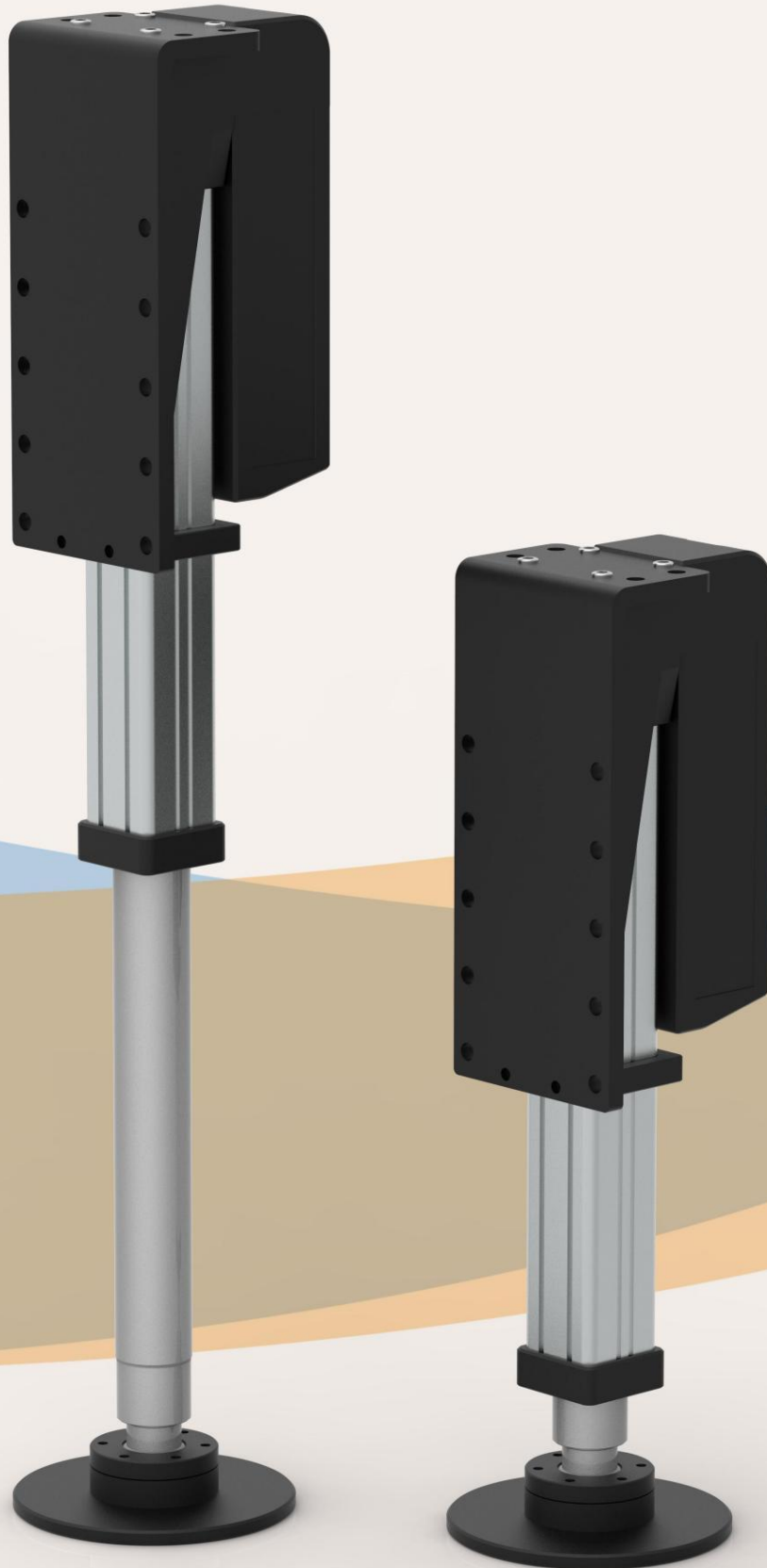

W90Z

Series
pushrod actuators

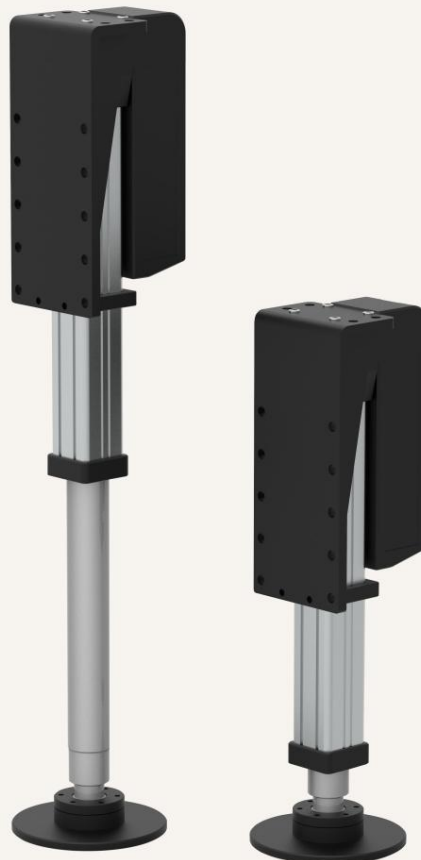

Product Category

1. Emergency vehicle application

2. RV Applications

3. Generator car

Parking lifters are key support devices for vehicles when parked, and they are mostly driven by mechanical or hydraulic methods to achieve height adjustment. Their main function is to stabilize the vehicle body and distribute the vehicle's weight by contacting the ground, effectively preventing tilting and swaying caused by uneven ground when parking.

This device is widely used in RVs, trucks, and construction vehicles, ensuring the safety of loading and unloading goods while also improving the stability and comfort of RVs when parked.

Parking is an important component of large vehicle parking systems.

Function Overview

Voltage range:	48V DC or 220V AC
Maximum thrust/support self-locking	7.0 tons / 12 tons
force: Speed at full load:	05 mm / s
Travel range:	100 - 500 MM
Retract to initial height:	travel +350mm
Dynamic lateral moment:	1500 Nm
Static lateral moment:	2000 Nm
Positioning repeatability:	±0.2-1 MM
Compatibility:	Any motorhome, emergency vehicle, etc., with a 0-stroke weight of 30KG and a 500MM stroke weight of +3KG.
Security Certification:	Comply with ISO9001-2008.
Operating temperature range:	-35 ° C ~ + 75 ° C
Complete performance temperature range:	+5 ° C ~ + 45 ° C
Protection rating:	IP65
Screw selection:	The default is a trapezoidal lead screw; a ball screw is optional.
Other options:	Feedback - Jobs and Status - Accessible Jobs
Control options:	Synchronous control, soft start and stop - achieving smooth operation
Communication protocol:	EtherCAN/Modbus RTU (customizable) with built-in high and low limit signals (PNP).
Origin signal:	

Standard stroke: Minimum \dot{y} 20mm. Please refer to the table below for maximum load and stroke.

Load (N)	Maximum travel (mm)
8000	50-400
4000	500-1200
3000	1201-2000

Remark:

Lateral moment in the Y direction = $X * 0.8$

Static lateral moment = Dynamic * 2

Dynamic lateral torque (Nm) - X direction

journey	S+400	S+500
1000-1200	500	600
1300-2500	350	500

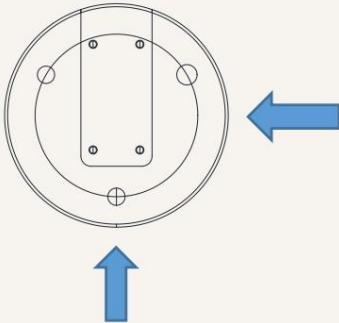

Lateral torque Y

Installation Dimensions Reference Chart

HT series	Travel ± 2 (mm)	Installation dimensions ± 2 (mm)
journey		
Installation dimensions		

CAN16F

Series
controller



Roofing system
with automatic leveling
system for outriggers